



DOOR

TITANE NEXT 75

↗ HIGH TRAFFIC COMMERCIAL DOOR

Easy to manufacture and assemble, TITANE NEXT 75 is a state-of-the-art shop front and commercial building aluminium door solution.

It offers exceptional thermal improvement and higher dimensions, providing a seamless blend of functionality, aesthetics, and energy efficiency.

DESIGN

- Concealed elements such as hinge, electromagnetic locks, and transom closer
- RAL colour options
- Available with Dual Colour option

LARGE DIMENSIONS

- Doors:
 - Module: 75 mm
 - Height: up to 3 meters
 - Width: up to 1.2 meters
 - Glazing thickness: up to 60 mm
 - Leaf weight: up to 110 kg
- Fixed parts:
 - Module: 100 mm
 - Height: up to 3 m
 - Glazing thickness:
 - Pocket rebate up to 32 mm
 - Open rebate up to 46 mm
 - Glass infill weight: up to 200 kg

PERFORMANCES

Endurance test for heavy traffic on transom closer:
up to 500,000 cycles

Thermal insulation: $U_w =$ up to 0.79 W/m²K

Weather performance complying to international standards:

- Air permeability: up to A2
- Water tightness: up to 3A
- Wind resistance: up to C3

APPLICATIONS

- Standard door, double action, 1 leaf or 2 leaves
- Panic exit door, single action, 1 leaf or 2 leaves
- Door with electromagnetic lock, single action, 1 leaf or 2 leaves
- Side light and other composite framing options

SAFETY & ACCESSIBILITY

- Low threshold 15 mm
- Panic exit door according to EN1125
- Finger protection system on the pivot side
- Burglary resistance PAS24
- Electromagnetic locks (optional)

CIRCULARITY

- TITANE NEXT commercial door is made in Hydro CIRCAL®, an aluminium made with a minimum of 75% recycled end-of-life aluminium.
- PVC-free components
- Dynamic EPD available in TechDesign
- 75% recycled and 95% recyclable
- Easy to dismantle for recycling



By  Hydro

APPLICATIONS

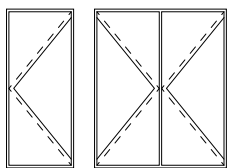

Stand-alone

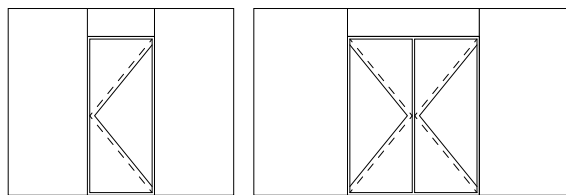

Compositions with fixed light

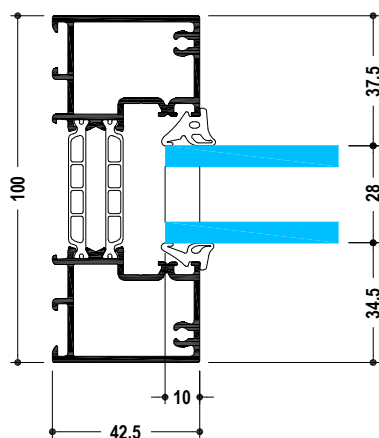

Pocket framing for glass up to 32 mm

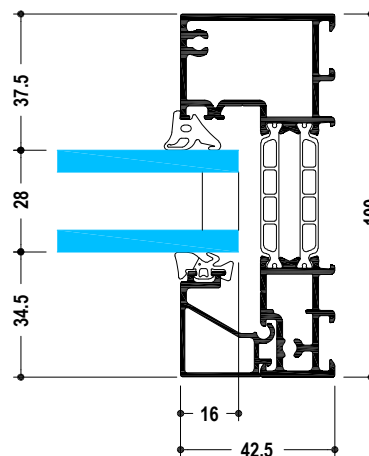

Open rebate for glass up to 51 mm

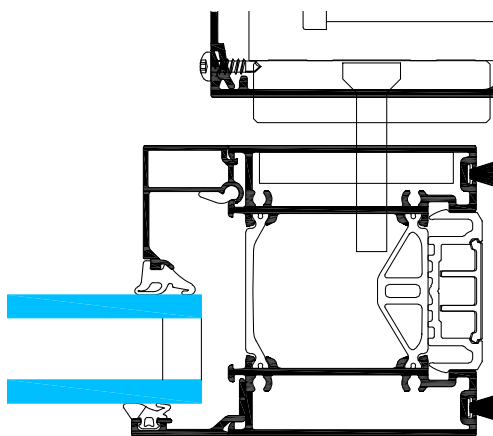

Integrated electro magnetic lock

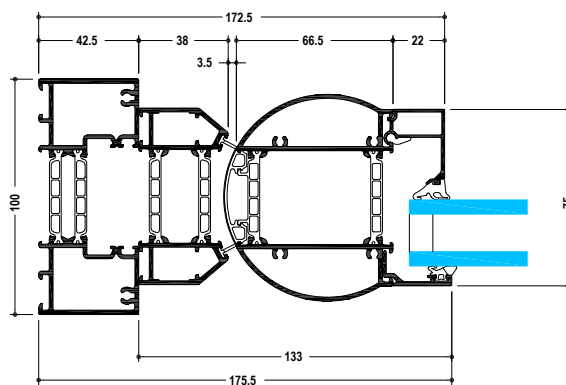

Anti-finger trap safety stile

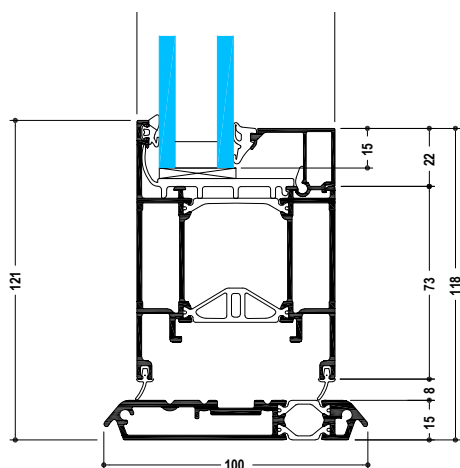

Low threshold 15 mm

Head Office:
Hydro Building Systems UK Ltd
Severn Drive, Tewkesbury,
Gloucestershire, GL20 8SF
+44 1684 853500
info.uk@hydro.com
www.technal.co.uk



By  Hydro